

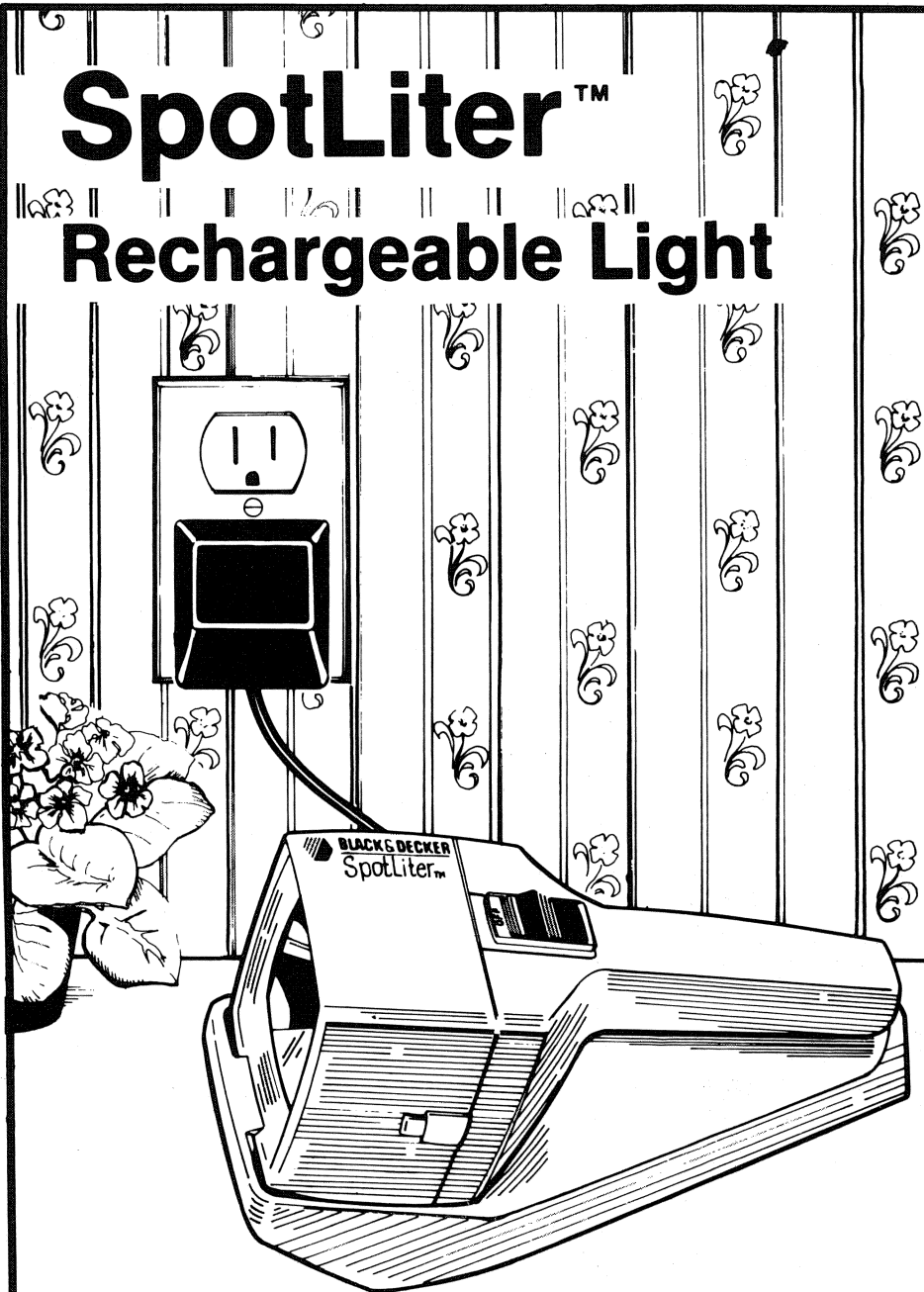

BLACK & DECKER®

SpotLiter™

Rechargeable Light



Model 9360/9360G

Listed by Underwriters Laboratories Inc.

SAVE THIS USE AND CARE BOOK

TABLE OF CONTENTS

Important Safeguards	1
Charging Procedure	3
Important Charging Notes	3
Bulb Replacement	4
Cleaning Plastic Parts	5
Mounting the Charging Base	5
Choosing a Charging Location	5
How To Mount The Charging Base	6
Need Service or Accessories?	7
Full Two-Year Warranty	7

IMPORTANT SAFEGUARDS

- **PLEASE READ THE SAFETY INSTRUCTIONS** in this manual and keep them for future reference. Before using SpotLiter™ Rechargeable Light, read all the instructions on the light, the charger plug, and the charging base.
- **CAUTION** — To reduce the risk of fire, electrical shock or personal injury, **DO NOT** attempt to use this charging system with a any other product. Likewise, **DO NOT** attempt to charge the SpotLiter™ Rechargeable Light with any other charging base.
- **DO NOT** expose the SpotLiter™ Rechargeable Light to rain or immerse in water. SpotLiter Rechargeable Light is not watertight.
- **DO NOT** abuse the cord. Never carry charger plug and charging base by cord or yank it to disconnect the charger plug from an outlet.
- **DO NOT** use an extension cord. Insert charger plug directly into an electrical outlet.
- **TO PROTECT AGAINST RISK OF ELECTRICAL SHOCK: DO NOT** put charging base in water or other liquid.
- **DO NOT OPERATE ANY APPLIANCE** with a damaged cord or charger plug, or after the appliance malfunctions, or is dropped, or damaged in any manner. Return the appliance to the nearest authorized Service facility for examination, repair, or electrical or mechanical adjustments.
- This appliance is intended for household use only and not for commercial or industrial use.
- **MAINTENANCE AND SERVICE**
UNPLUG the charger plug from the outlet before attempting any routine cleaning or maintenance of the charging base.
DO NOT try to repair the unit, charger plug or charging base yourself. Take it to a Black & Decker (U.S.) Inc. Household Appliance Company-Owned or Authorized Service Center.
- **DO NOT** operate a damaged charging system. Have damaged cords, charger plugs or charging bases replaced immediately.
DO NOT incinerate the SpotLiter™ Rechargeable Light even if it is severely damaged. The batteries can explode in a fire.

SAVE THESE INSTRUCTIONS

Thank you for purchasing the SpotLiter™ Rechargeable Light. Before first use, please take a few minutes to read this Use & Care Book and to find a place to keep it handy for reference. Review the product warranty and service statements. Then fill out the owner registration form and mail it in. For your convenience, please record:

Date Product Received: _____

Complete Model/Catalog Number: _____
(located on bottom of Head of Light)

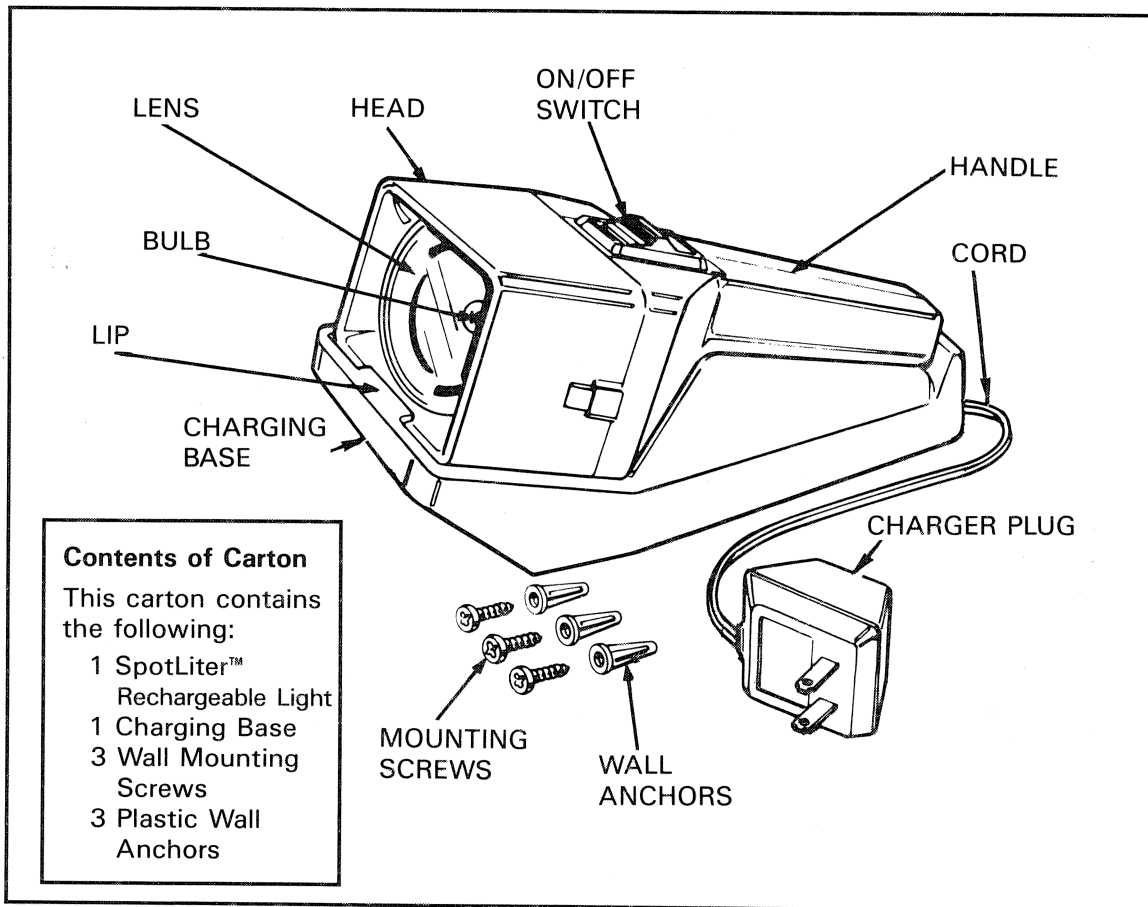

You will soon find that your SpotLiter™ Rechargeable Light is convenient to use around the house, car, camper and boat. It has been designed for many years of efficient service. Your SpotLiter™ Rechargeable Light uses high energy rechargeable nickel cadmium batteries. You can expect about 60 minutes of light from a single charge.

When kept in its Charging Base, the SpotLiter™ Rechargeable Light is on continuous charge and is ready for immediate use at a cost of only pennies a month.

CHARGING PROCEDURE

1. Place the SpotLiter™ Light into the Base by first putting the Lens end of the Light under the Lip at the lower end of the Base. (Figure 1) Then push the Handle end down until you hear a click. (Figure 2)

FIGURE 1

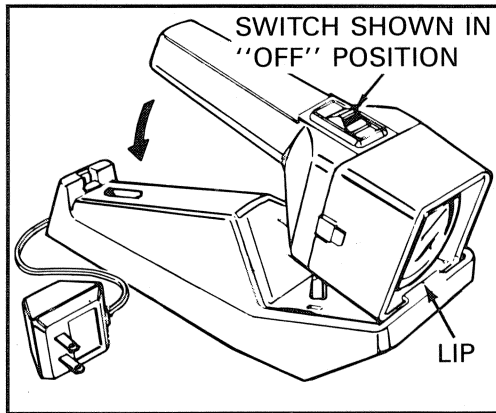
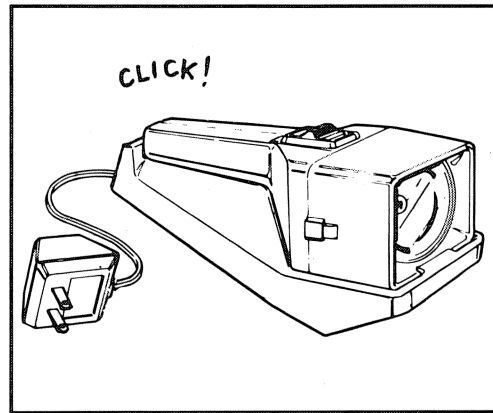

FIGURE 2



2. Plug Charger Plug into a 120 volt receptacle. The Charger Plug can only be used with 60 cycle 120 volts A.C. (normal house current). The Charger Plug is designed to be left plugged in at all times.
3. The SpotLiter™ Light is designed so that it is continuously charging while the Light is mounted in the Charging Base. It is recommended that the SpotLiter™ Light be kept on charge in the Base so that it will always be ready to use. The batteries require 24 hours to reach full capacity, and 10 hours to reach 60% capacity.
4. The exposed electrical terminals mounted in the Base are at low voltage A.C. AND ARE NOT A SHOCK HAZARD.

Important Charging Notes

1. Longest life and best performance can be obtained if the SpotLiter™ Light is used often and the batteries are charged at normal household temperatures.
2. While charging, the Charger Plug will become warm to the touch.
3. If after repeated use the run time seems to get shorter, it may not be the result of faulty batteries. This condition can be remedied by leaving the unit on until the light becomes dim. Then recharge the unit for 24 hours. This procedure improves the capacity of the batteries. You may need to repeat this a few times for best results.
4. If Light does not function, check to see if the Charger Plug is plugged into outlet; make sure the outlet is not controlled by a wall switch. Also check for a blown fuse.

BULB REPLACEMENT

1. To reach the Bulb, the Head can be removed from the Handle by inserting the flat tip of a screwdriver into the slot located on the side of the Head. Lift the screwdriver up slightly to release the Head from the Handle. (Figure 3)

FIGURE 3

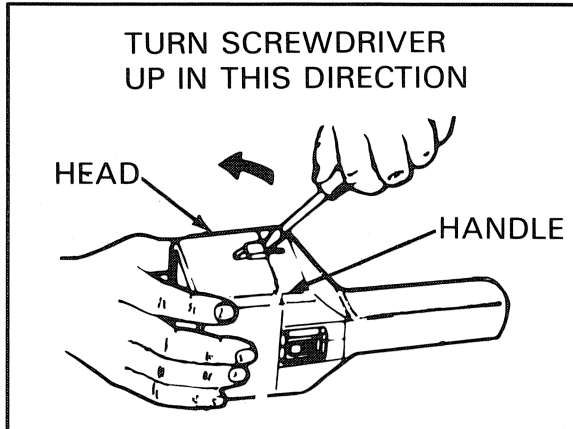

NOTE: Two bright metal contacts will be exposed inside the housing. Care should be taken not to bend these when disassembling and reassembling. (Figure 4)

FIGURE 4

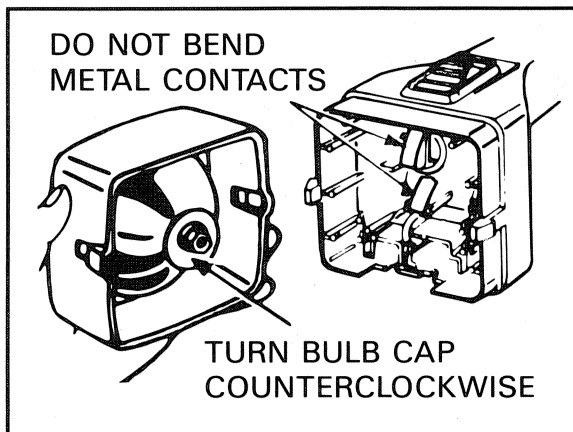

2. Remove the Bulb from the back of the reflector and replace it with a new Bulb. (Figure 4)

A replacement bulb is available at local Black & Decker (U.S.) Inc., Household Appliance Company-Owned or Authorized Service Centers or on the order form located on the back page of this book. Also KPR102 or K-2 Krypton bulbs, or PR2 bulbs may be substituted, and are available at many retail stores. The performance of these bulbs is less than the Xenon bulb, but may be used satisfactorily.

3. Position the Head so that the SpotLiter™ name is on the same side as the On/Off Switch. Hold the Head in one hand and the Handle in the other. Slide the square hole on the side of the Head over the Notch on the side of the Handle. With firm pressure, press the Head and Handle until they snap together. Do not attempt to snap both sides together at once. (Figure 5)
4. For your convenience, a built-in holder provides handy storage for a spare bulb. (Figure 6)

FIGURE 5

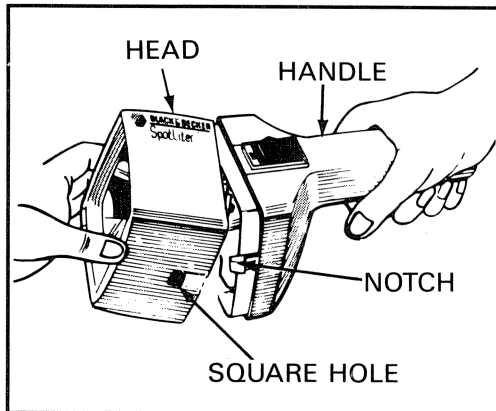
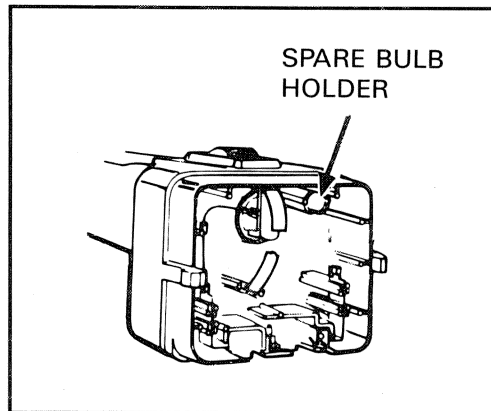

FIGURE 6



CLEANING PLASTIC PARTS

Use only mild soap (no abrasives) and a cloth dampened with warm water to clean the plastic parts. Avoid all other types of detergents, cleaners or solvents, which might contain chemicals that could seriously damage the plastic. For best performance, keep the Lens clean using a damp cloth.

MOUNTING THE CHARGING BASE

Choosing a Charging Location

1. Charge the Light indoors; never expose it to the weather.
2. Do not store the SpotLiter™ Rechargeable Light in locations where the temperature may reach 120°F or more (such as outside sheds or metal buildings in the summer).
3. Do not charge the batteries when the temperature is below +40°F or above +105°F. Damage to the batteries may occur.
4. Mount the Charging Base away from water, a high heat source, or flame. Keep the cord away from sharp edges, oil and other chemicals.
5. Use the Charger Plug only with standard household outlets, (120 volts A.C., 60 Hz).

How to Mount the Charging Base

1. The Charging Base is designed to be mounted vertically on a wall or

horizontally on a shelf or other surface. (Figure 7) Mounting the Light will enable you to find it easily in case of an emergency.

FIGURE 7

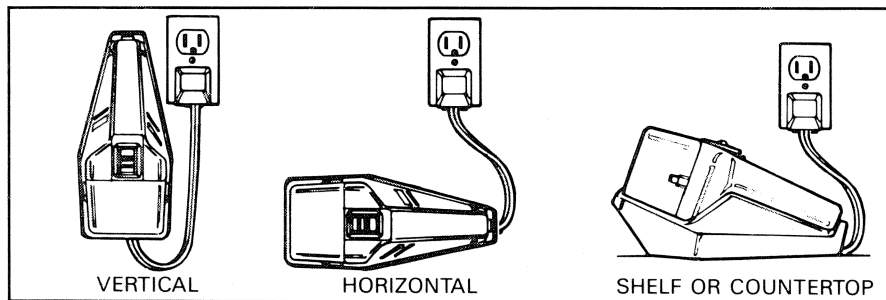

2. To mount the Charging Base:

- Place it against the surface where it is to be mounted. Mark screw centers at the small end of all key slots. (Figure 8)

FIGURE 8

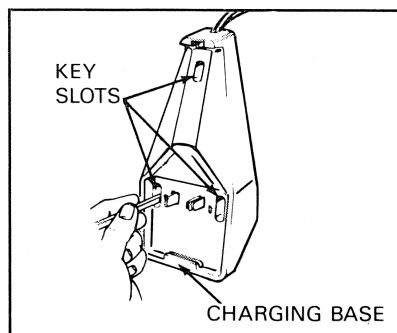
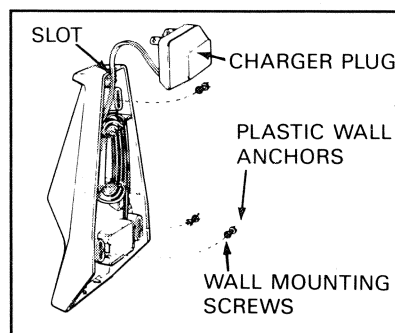

FIGURE 9



- If mounting the Base to drywall or plaster wall, drill 3/16" diameter holes on the marked centers and push the plastic wall anchors fully into the holes.
- Turn the screws into the wall leaving 1/4" of the screws exposed. Place the Base on the mounting screws and slide into place. Tighten screws snugly against the Base. (Figure 9)

3. If the Base is to be mounted close to an outlet, the excess cord can be tied and folded or wrapped in the cord storage area on the underside of the Base. The cord can slide into the slots on the sides of the Charging Base.

NEED SERVICE OR ACCESSORIES?

Service, if necessary, must be performed by a Black & Decker (U.S.) Inc., Household Appliance Company-Owned or Authorized Service Center. The Service Center nearest you can be found in the yellow pages of your phone book under "Electric Appliances — Small — Repairing."

If mailing or shipping your SpotLite™ Rechargeable Light, pack it carefully in its original carton or any sturdy carton with enough packing material to prevent damage. Include a note describing the problem to our Service Center and be sure to give your return address. We also suggest that you insure the package for your protection.

Consumer-replaceable parts and accessories are also available at Black & Decker (U.S.) Inc., Household Appliance Company-Owned or Authorized Service Centers.

FULL TWO-YEAR WARRANTY

(Excluding Bulb)

Black & Decker (U.S.) Inc. warrants this product against any defects that are due to faulty material or workmanship for a two-year period after the original date of purchase or receipt as a gift. This warranty does not include damage to the product resulting from accident or misuse.

If the product should become defective within the warranty period, we will repair it or elect to replace it free of charge. We will return your product, transportation charges prepaid, provided it is delivered prepaid to any Black & Decker (U.S.) Inc., Household Appliance Company-Owned or authorized service Center.

This warranty gives you specific legal rights, and you may also have other rights which vary from state to state.

Answers to any questions regarding warranty service/locations may be obtained by writing:

Consumer Assistance and Information
Black & Decker (U.S.) Inc.
6 Armstrong Road
Shelton, CT 06484

SpotLiter™ Replacement Bulb Order Form

Name _____

Street Address _____

City _____ State _____ Zip _____

Phone Number _____

Mail Order Form To: Black & Decker SpotLiter™ Bulb Offer
P.O. Box 600
Hampstead, MD 21074-0600

Method of Payment: Do Not Send Cash. C.O.D. Orders Not Accepted. Check or M.O. Payable to Black & Decker (U.S.) Inc.

VISA MASTERCARD DISCOVER CARD NUMBER _____

Exp. Date: _____ mo. _____ yr. _____ cardholder's signature

Offer good in the United States only. Allow 4-5 weeks for delivery. Prices subject to change.

OFFICE USE ONLY	PRODUCT DESCRIPTION	PART NUMBER	QTY.	PRICE EACH	TOTAL AMOUNT
1	Xenon Bulb	168002-00		\$2.00	
1	Kit A — Package of 3 Xenon Bulbs	3-168002-00		\$4.80 (Save 20%)	
SUBTOTAL					\$
ADD LOCAL SALES TAX (EXCEPT AK, DE, DC, ID, MS, MT, NH, ND, OR, PR, RI, SD, VT, WY)					\$
ADD SHIPPING/HANDLING					\$.75
TOTAL AMOUNT					\$

Pub. No. 168642-13
Printed in U.S.A.